

Safety notes:

- Installation should be performed only by qualified electrician .
- Make sure no voltage while installation .
- Connect cable wires according to wire labeling.
- Max current should not exceed 16A in one power feed in circuit.

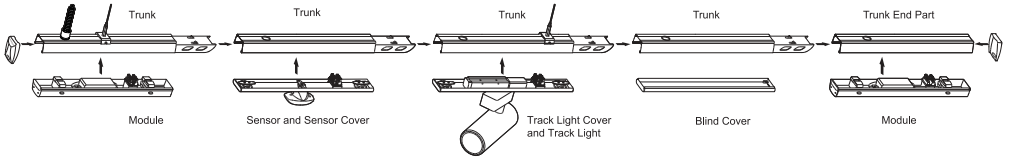

Trunk and Module

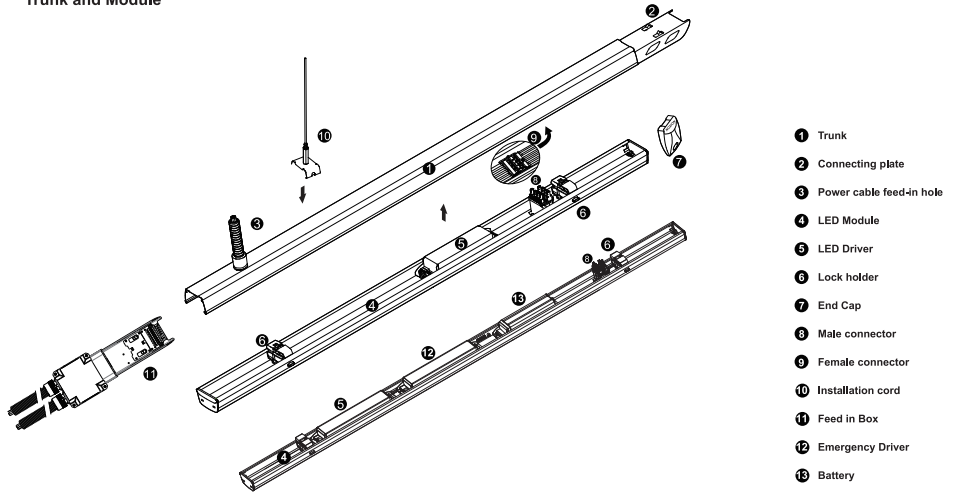

- 1 Trunk
- 2 Connecting plate
- 3 Power cable feed-in hole
- 4 LED Module
- 5 LED Driver
- 6 Lock holder
- 7 End Cap
- 8 Male connector
- 9 Female connector
- 10 Installation cord
- 11 Feed in Box
- 12 Emergency Driver
- 13 Battery

Step 1 Mounting Suspension



1. Drill a hole in the ceiling

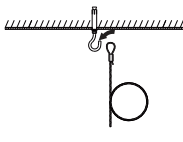

2. Fix mounting hook into the ceiling

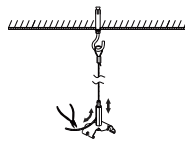

3. Adjust length of suspension cord:
a. press down Hexagon bolt;
b. Pull in/out cord to adjust length

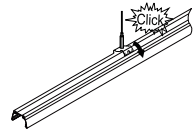

4. Click the mounting clip into the trunk

DIP:

50W:

<p>Input: 220-240V~ U_{out}: 250V= LED Linear Lighting 0/50/60Hz 0.33A Output Voltage: 65~160V= PF: 0.9 Output Current: 0.35A max I_a: 55°C t_c: 80°C Output Power: 50W max Made in China</p>	<p>LED DRIVER Model: CSD2S - 50A 0.5 - 1.5mm²</p>	<p>LED + ⊕ LED - ⊖</p>
<p>CE RoHS</p>	<p>OFF OFF 50W 0.350A ON OFF 45W 0.315A OFF ON 40W 0.280A ON ON 35W 0.245A</p>	<p>1 2</p>

LED Linear Light NX-Line

70W:

	Input: 220-240V~ 0/50/60Hz 0.47A PF: 0.9 ta: 60°C tc: 80°C Made in China	Uout: 250V~ Output Voltage: 120-200V~ Output Current: 0.35A max Output Power: 70W max	LED DRIVER Model: CSD2S - 70A 	LED + ⊕ LED - ⊖ 1 2 OFF OFF 70W 0.350A ON OFF 65W 0.325A OFF ON 60W 0.300A ON ON 55W 0.275A	1 2 OFF OFF 70W 0.350A ON OFF 65W 0.325A OFF ON 60W 0.300A ON ON 55W 0.275A	
					CE RoHS	
					LED Linear Lighting System	
					Made in China	

	Input: 220-240V~ 0/50/60Hz 0.47A PF: 0.9 ta: 60°C tc: 80°C Made in China	Uout: 250V~ Output Voltage: 100-160V~ Output Current: 0.44A max Output Power: 70W max	LED DRIVER Model: CSD2S - 70D 	LED + ⊕ LED - ⊖ 1 2 OFF OFF 70W 0.44A ON OFF 61W 0.38A OFF ON 51W 0.32A ON ON 42W 0.26A	1 2 OFF OFF 70W 0.44A ON OFF 61W 0.38A OFF ON 51W 0.32A ON ON 42W 0.26A	
					CE RoHS	
					LED Linear Lighting System	
					Made in China	

DALI:

50W:

	Input: 220V - 240V ~ 0/50/60Hz 0.47A PF: 0.9 ta: 60°C tc: 80°C Made in China	Uout: 50V ~ Output Voltage: DC30 - 42V Output Current: 1.18A max Output Power: 50W max	LED DRIVER Model: CSD2H - 50 - DT6 	LED + ⊕ LED - ⊖ 1 2 OFF OFF 50W 1.18A ON OFF 45W 1.07A OFF ON 40W 0.95A ON ON 35W 0.84A	1 2 OFF OFF 50W 1.18A ON OFF 45W 1.07A OFF ON 40W 0.95A ON ON 35W 0.84A	
					DALI logo	
					LED Linear Lighting System	
					Made in China	

70W:

	Input: 220V - 240 V ~ 0/50/60Hz 0.47A max PF: 0.9 ta: 60°C tc: 85°C Made in China	Uout: 50V ~ Output Voltage: DC30 - 42V Output Current: 1.65A max Output Power: 69W max	LED DRIVER Model: CSD2H - 70 - DT6 	LED + ⊕ LED - ⊖ 1 2 OFF OFF 69W 1.65A ON OFF 64W 1.53A OFF ON 60W 1.42A ON ON 55W 1.30A	1 2 OFF OFF 69W 1.65A ON OFF 64W 1.53A OFF ON 60W 1.42A ON ON 55W 1.30A	
					DALI logo	
					LED Linear Lighting System	
					Made in China	

Step 2 Connecting Power Supply

Power connection option 1

Connect power cable from back of Trunk with feed-in connector



1. Cut the Rubber cap to pass the power cable



2. Screw in the cable gland

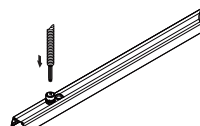

3. Put the cable inside and pull up cable gland to lock

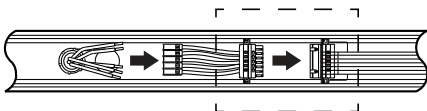

4. connect the wires according to the label

LED Linear Light NX-Line

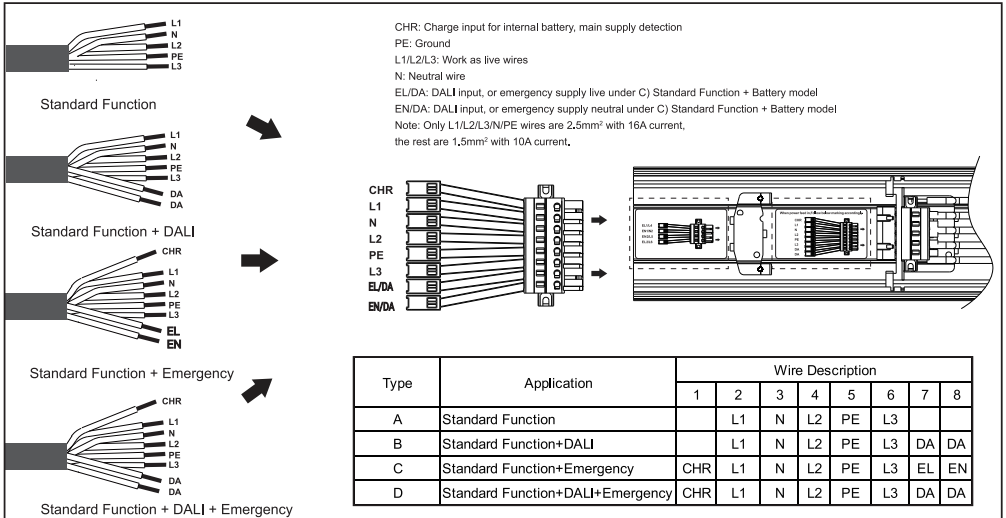

Type	Application	Wire Description							
		1	2	3	4	5	6	7	8
A	Standard Function		L1	N	L2	PE	L3		
B	Standard Function+DALI		L1	N	L2	PE	L3	DA	DA
C	Standard Function+Emergency	CHR	L1	N	L2	PE	L3	EL	EN
D	Standard Function+DALI+Emergency	CHR	L1	N	L2	PE	L3	DA	DA

Power connection option 2

Connect power cable with Feed In Box

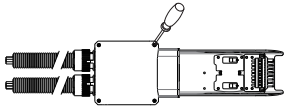

1. open the cover of the Feed In Box

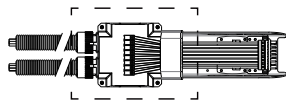

2. Connect the wires according to the label

Easy installation:
 Default feed-in and feed-out connector have been wired, they can connect to the trunking rail directly
 A feed-in box has function of feed-in, connection, transfer and so on

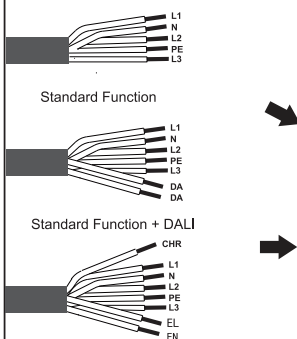

CHR: Charge input for internal battery, main supply detection
 PE: Ground
 L1/L2/L3: Work as live wires
 N: Neutral wire
 EL/DA: DALI input, or emergency supply live (under C) Standard Function + Battery model
 EN/DA: DALI input, or emergency supply neutral (under C) Standard Function + Battery model
 Note: Only L1/L2/L3/N/PE wires are 2.5mm² with 16A current, the rest are 1.5mm² with 10A current.

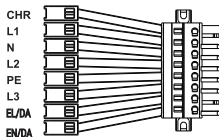

LED Linear Light NX-Line

Standard Function + Emergency

Standard Function + DALI + Emergency

3. Fix the cover and Feed In Box

Type	Application	Wire Description							
		1	2	3	4	5	6	7	8
A	Standard Function								
B	Standard Function+DALI		L1	N	L2	PE	L3	DA	DA
C	Standard Function+Emergency	CHR	L1	N	L2	PE	L3	EL	EN
D	Standard Function+DALI+Emergency	CHR	L1	N	L2	PE	L3	DA	DA

4. Click in Feed In Box into Trunk

Step 3 Connecting the Trunk

Both trunking rails should keep in perfect position then push and click



Step 4 Mounting Module

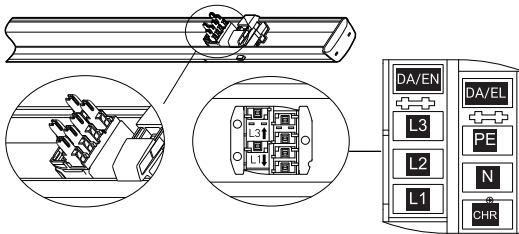

1. Slide knob to select phase L1/L2/L3

Female connector on Trunk

Male connector on Module

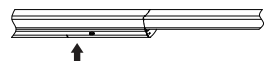
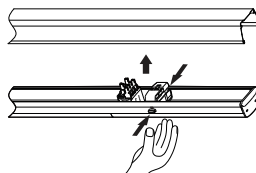
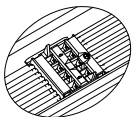

2. Make sure the male & female connector is in the right position . Then fix the module to the trunking rail according to above pictures.

Step 5 LED Linear Lighting system

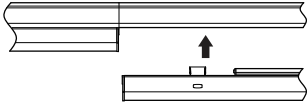

Including Module

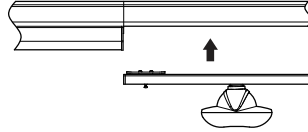

Including Sensor and Sensor Cover

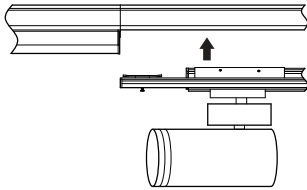

Including Track Light Cover

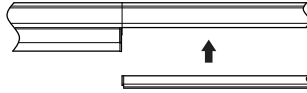

Including Blind Cover

Step 6 Last Step



Option 1

Use the trunking rail end part for the end of a line.
Push the sliding lock to lock the module to the trunking rail end part, and attach the end cap.



Option 2

Push the feed out box inside the trunking rail with connector to close the line.

Wire diagram of triple circuits function

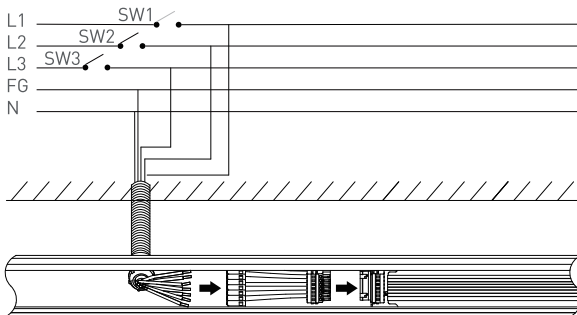

This Triple Circuits function offers to control lighting ON/OFF by three switches SW1, SW2, SW3, which are connected by live lines L1, L2, L3.

Pendant Mounting Installation

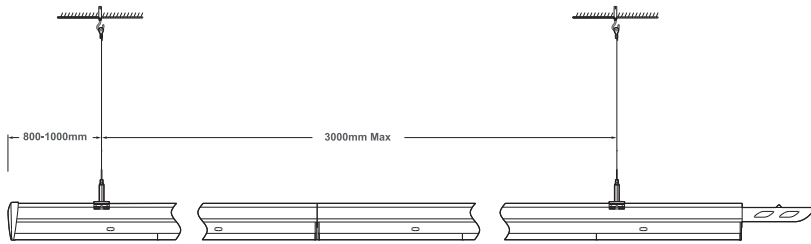

Starting Installation distances point should be 800 mm to 1000 mm, then in between 1st & 2nd point should be 3000 mm max.

Five options for installation

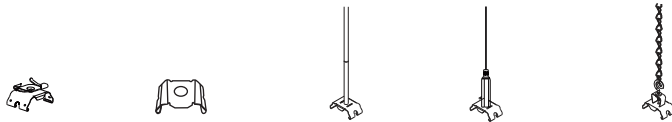

Surface mounting kit

Surface mounting clip

Suspension Rod

Suspension Cord

Suspension Chain

Node Connectors

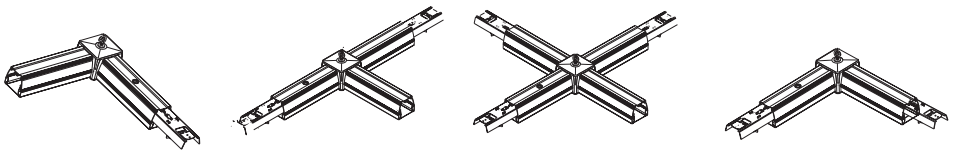

100-800mm

3000mm Max.

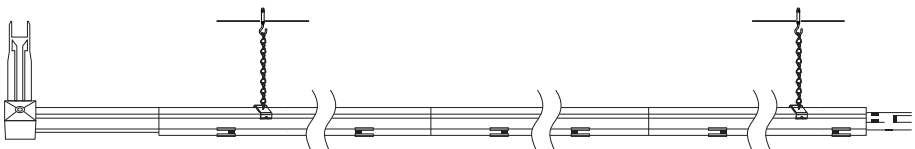

Type 1:

Internal Emergency Power Supply Module

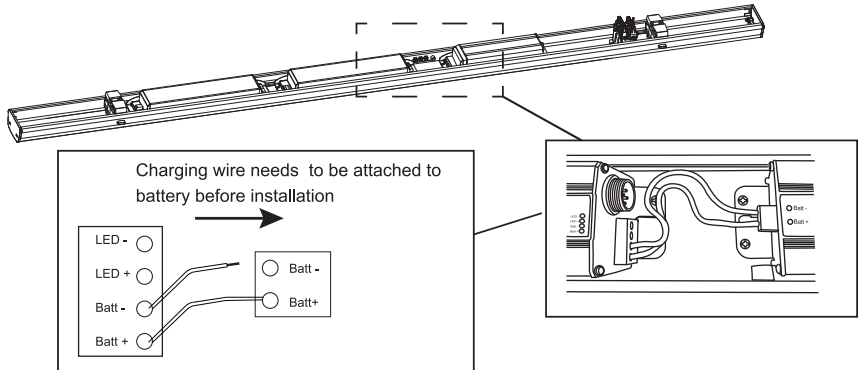

SW: test button

Indicator Light: failure;charging;main supply

Explanation of LED indicator

State	Color	LED indication	Status	Comment
	Green	Slow flashing green (3 sec on, 1 sec off)	Charging Mode	AC mode
	Green	Permanent green	Fully Charged	AC mode
	Green	Fast flashing green (0.1 sec on, 0.1 sec off)	Function test underway	
	Green	Slow flashing green (1 sec on, 1 sec off)	Duration test underway	
	Red	Permanent red	Load failure	Open circuit/ Short circuit Led failure (emergency mode)
	Red	Slow flashing red (1 sec on, 1 sec off)	Battery failure	Battery failed the duration test or function test / No battery
		Green and red off	DC mode	Battery operation(emergency mode)

Test switch

The test button is an open switch, if you press it, it connects, and then you release it, it cuts off automatically.

When you are doing the daily maintenance, if you press the test button, the emergency driver goes into emergency mode, if you release the button, the emergency driver will go back to normal mode

Battery replacement

Turn off main power, enter emergency mode, press test switch longer than 3 seconds, replace battery, turn on main power.

Type 2:

Internal Emergency Power Supply Module

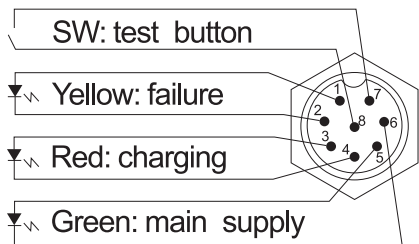
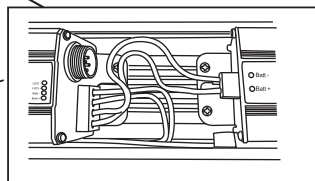
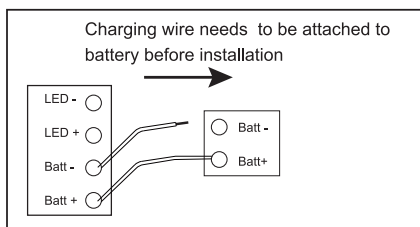
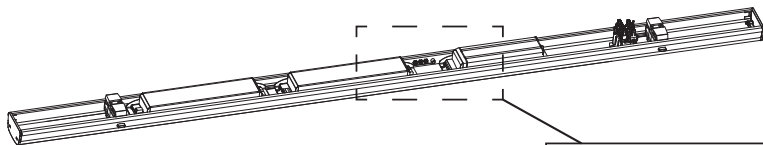

Signals of the indicators are as following.

Green indicator: On----Mains supply is connected
Off----Mains supply is disconnected

Red indicator: On----Battery is charging
Off----Battery charging finished

Yellow indicator: On----System failure
Off----Working

EN The luminaire shall be installed and maintained by a qualified electrician, in accordance with the national regulations in each country. The luminaire contains no replaceable parts. In case of the luminaire is damaged, it shall be exclusively replaced by the manufacturer or authorized dealer. Keep the operating manual for later use. The manufacturer is not responsible for the incorrect use and assembly of this product.

NL De armatuur dient te worden geïnstalleerd en onderhouden door een erkend installateur, in overeenstemming met de nationale regelgeving in het betreffende land. De armatuur bevat geen vervangbare onderdelen. Indien de armatuur is beschadigd dient deze enkel te worden vervangen door de fabrikant of door een erkende dealer. Bewaar de handleiding voor later gebruik. De fabrikant is niet verantwoordelijk voor onjuist gebruik en/of installatie van dit product.

DE Die Leuchte muss von einem qualifizierten Elektriker gemäß den nationalen Vorschriften in jedem Land installiert und gewartet werden. Die Leuchte enthält keine austauschbaren Teile. Falls die Leuchte beschädigt ist, wird sie ausschließlich durch den Hersteller oder den autorisierten Händler ersetzt. Bewahren Sie die Bedienungsanleitung für spätere Verwendung auf. Der Hersteller ist nicht verantwortlich für die unsachgemäße Verwendung und Montage dieses Produktes.

FR Le luminaire doit être installé et entretenu par un électricien qualifié, conformément à la réglementation nationale de chaque pays. Le luminaire ne contient pas de pièces remplaçables. Dans le cas où le luminaire est endommagé, il doit être remplacé exclusivement par le fabricant ou le revendeur agréé. Conservez le mode d'emploi pour une utilisation ultérieure. Le fabricant n'est pas responsable de l'utilisation et du montage incorrects de ce produit.

IT L'apparecchio deve essere installato e mantenuto da un elettricista qualificato seguendo le normative nazionali di riferimento. L'apparecchio non contiene parti sostituibili. In caso di rottura sarà sostituito esclusivamente dal produttore o da un rivenditore autorizzato. Conservate il manuale di installazione per eventuali utilizzi successivi. Il produttore non è responsabile per l'utilizzo ed il montaggio non corretto di tale apparecchio.

ES La luminaria debe de ser instalada y mantenida por un electricista cualificado, siguiendo las regulaciones nacionales de cada país. La luminaria contiene partes no reemplazables. En el caso de que la luminaria sea dañada, deberá ser reemplazada exclusivamente por el fabricante o distribuidor autorizado. Guarde el manual para usos posteriores. El fabricante no es responsable por el uso e instalación incorrecta de este producto.

EN1 The luminaire shall be installed and maintained by a qualified electrician, in accordance with the national regulations in each country. The luminaire contains no replaceable parts. In case of the luminaire is damaged, it shall be exclusively replaced by the manufacturer or authorized dealer. Keep the operating manual for later use. The manufacturer is not responsible for the incorrect use and assembly of this product.

SE Armaturen ska installeras och underhållas av en behörig elektriker i enlighet med nationella föreskrifter i respektive land. Armaturen innehåller inga utbytbara delar. Om armaturen är skadad ska den utslutande bytas ut av tillverkaren eller en auktoriserad återförsäljare. Spara bruksanvisningen för framtida bruk. Tillverkaren ansvarar inte för felaktig användning eller montering av denna produkt.

DK Armaturet skal installeres og vedligeholdes af en kvalificeret elektriker i overensstemmelse med de nationale forskrifter i hvert land. Armaturet indeholder ingen udskiftelige dele. Hvis armaturet bliver beskadiget, skal det udelukkende udskiftes af producenten eller en autoriseret forhandler. Opbevar brugsanvisningen til senere brug. Producenten er ikke ansvarlig for ukorrekt brug eller montering af dette produkt.

NO Armaturen skal installeres og vedlikeholdes av en kvalifisert elektriker i samsvar med nasjonale forskrifter i hvert land. Armaturen inneholder ingen utskiftbare deler. Dersom armaturen blir skadet, skal den utelukkende erstattes av produsenten eller en autorisert forhandler. Oppbevar bruksanvisningen for senere bruk. Produsenten er ikke ansvarlig for feil bruk eller montering av dette produktet.

FI Valaisin on asennettava ja huollettava pätevän sähköasentajan toimesta kunkin maan kansallisten määräysten mukaisesti. Valaisimessa ei ole vaihdettavia osia. Jos valaisin vahingoittuu, se tulee vaihtaa ainoastaan valmistajan tai valtuutetun jälleenmyyjän toimesta. Säilytä käyttöohje myöhempää tarvetta varten. Valmistaja ei ole vastuussa tämän tuotteen virheellisestä käytöstä tai asenuksesta.

PL Oprawa oświetleniowa musi być instalowana i konserwowana przez wykwalifikowanego elektryka, zgodnie z krajowymi przepisami obowiązującymi w danym kraju. Oprawa nie zawiera części wymiennych. W przypadku uszkodzenia oprawa musi zostać wymieniona wyłącznie przez producenta lub autoryzowanego dystrybutora. Zachowaj instrukcję obsługi do późniejszego wykorzystania. Producent nie ponosi odpowiedzialności za nieprawidłowe użycie lub montaż tego produktu.